

Dated.....*8th August*.....2024

**THE CITY OF BRADFORD METROPOLITAN DISTRICT COUNCIL
(TOLLER LANE AND WHETLEY HILL, BRADFORD)
(HIGHWAY JUNCTION IMPROVEMENT SCHEME)
COMPULSORY PURCHASE ORDER 2021**

GENERAL VESTING DECLARATION

**-made and executed by-
The City of Bradford Metropolitan District Council**

**-pursuant to-
The Compulsory Purchase (Vesting Declarations) Act 1981**

**-in respect of -
Leasehold Estate comprising 11 square metres of land of part of the frontage
to No 112 Whetley Hill, Bradford BD8 8NA**

**Jason Field
Director of Legal and Governance
Department of Corporate Resources,
The City of Bradford Metropolitan District Council,
City Hall, Centenary Square, Bradford
West Yorkshire BD1 1HY**

This **GENERAL VESTING DECLARATION** is executed on the...8th...day of...August.....2024

by The City of Bradford Metropolitan District Council ("**the Authority**")

WHEREAS

On 16th July 2021 an order entitled The City of Bradford Metropolitan District Council (Toller Lane and Whetley Hill, Bradford) (Highway Junction Improvement Scheme) Compulsory Purchase Order 2021 was confirmed by the Secretary of State for Transport under the powers conferred on him by the Highways Act 1980 authorising the Authority to acquire the land specified in the Schedule hereto.

Notice of confirmation of the order was first published in accordance with section 15 of the Acquisition of Land Act 1981 on 19th August 2021.

That notice included the statement and form prescribed under section 15(4) (e) and (f) of the Acquisition of Land Act 1981.

NOW THIS DEED WITNESSETH that, in exercise of the powers conferred on them by section 4 of the Compulsory Purchase (Vesting Declarations) Act 1981 ("**the Act**"), the Authority hereby declare the land described in the Schedule hereto being part of the land authorised to be acquired by the order and more particularly delineated on the plan annexed hereto, together with the right to enter and take possession of the land shall vest in the Authority as from the end of the period of three months from the date on which the service of notices required by section 6 of the Act is completed.

SCHEDULE

ALL THAT leasehold estate comprising 11 square metres of land forming part of the frontage to No 112 Whetley Hill, Bradford, as shown more particularly delineated and edged red on the plan annexed hereto, being part of the land in a Lease registered at HM Land Registry under Title number WYK328743.

EXECUTED as a **DEED** by affixing
the **COMMON SEAL** of
The City of Bradford Metropolitan District Council
in the presence of



Authorised Signatory



103523B

Dated...8th...August...2024

MS P

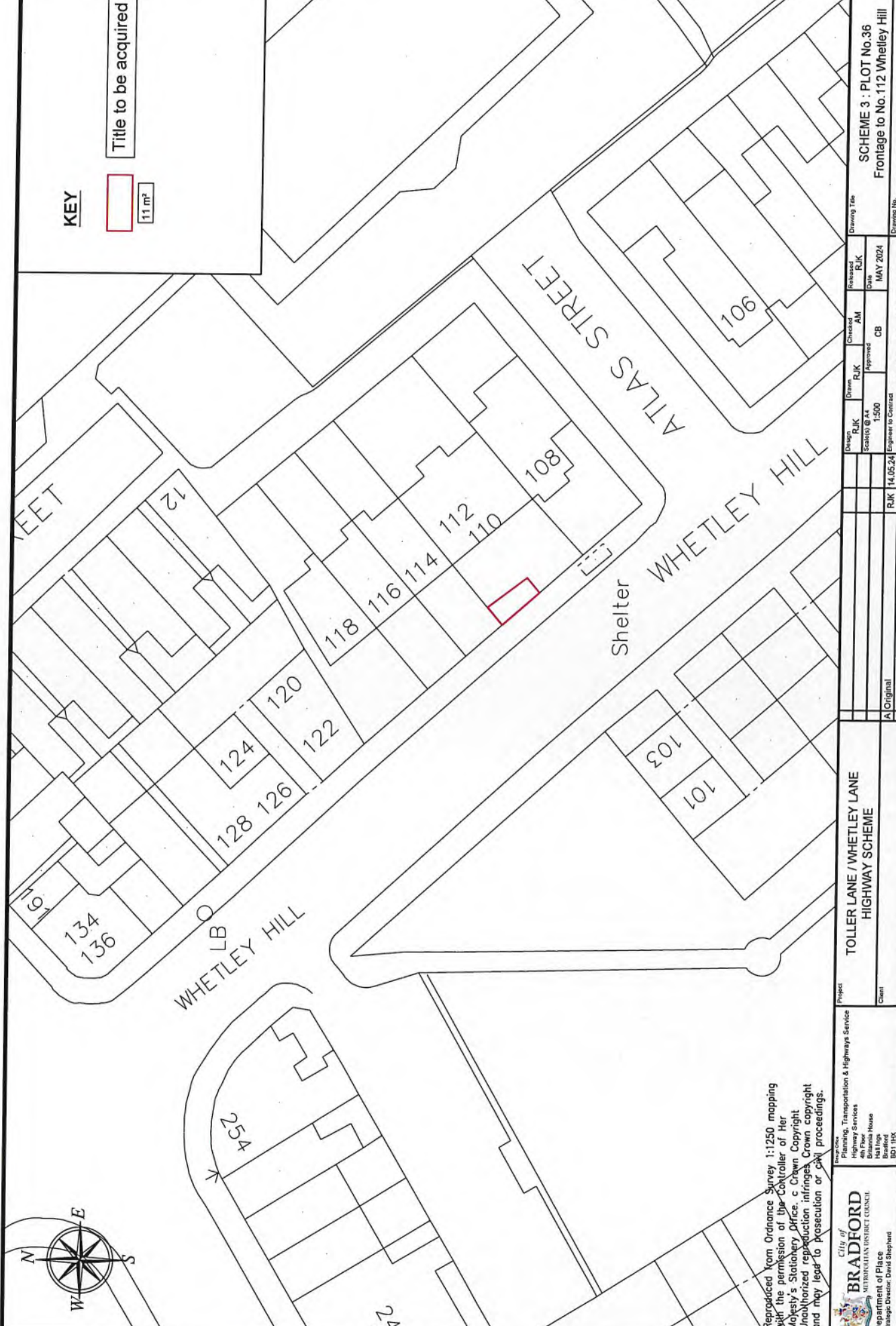

KEY

Title to be acquired



11 m²

Reproduced from Ordnance Survey 1:1250 mapping with the permission of the Controller of Her Majesty's Stationery Office, © Crown Copyright. Unauthorised reproduction infringes Crown copyright and may lead to prosecution or civil proceedings.



Service: Planning, Transportation & Highways Service
4th Floor
City Hall
Bradford House
Hallgate
Bradford
BD1 1XK

Project: TOLLER LANE / WHETLEY LANE HIGHWAY SCHEME

Original	Revision
A	

Drawn	Checked	Approved	Engineer to Contract
RJK	RJK	CB	Richard Gelder B.Eng (Hons) J.Eng MICE
Scale 1:500			

Released	Date
RJK	MAY 2024

Drawing Title: SCHEME 3 : PLOT No.36
Frontage to No.112 Whetley Hill
Drawing No.: PTH-HS-105425-TOL-GVD-36A

